











Made in Italy

 Litus 1.1, code: LT111015SNV  
Recessed for outdoor applications

24/11/2024 Rev. 30

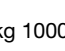

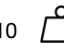
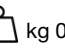

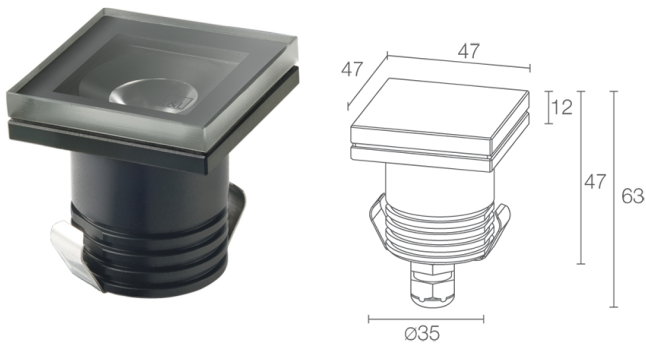





**CASAMBI**

T max 40°C 



## DESCRIPTION

recessed for outdoor applications; drive-over up to 1000 kg; recessed (ceiling, wall, floor); Power consumption: max 2W; Power supply: max 700mA; Lumen output at source: 196 lm (3000K, 700mA, CRI >90); Delivered lumen output: 165 lm (3000K, 700mA, 22°, CRI >90); 1 power LED, 1/4 ANSI BIN, 50 000h L90 B10 (Ta 25°C); LED colour: 3000K; Optics: 13°: optical system consisting of a high-efficiency TIR lens combined with a high-quality technical filter; CRI Colour Rendering Index: >90; Body material: body made of ANTICORODAL 6082 aluminium alloy, made entirely on a CNC lathe and then electro-coloured black; Screen material: 6-mm-thick transparent extra-clear glass, high transmittance to ensure chromatic uniformity of light and tempered for excellent resistance to knocks and scratches, with a RAL 7015 signal grey serigraphed border; Thickness of installation surface: 12.5 mm; power supply unit not included; Wiring: series; includes 1.5 m neoprene cable H05RN-F 2x0.75/0.75 Ø6.3 mm; Control system: dimming via dimmable driver; Ingress protection: IP67; Impact resistance: IK08; version with screen in serigraphed-white glass available on request; Casambi control using the Casambi app with dedicated electronics; Protection systems: IPS (Intelligent Protection System) protects lighting fixtures from water infiltrations, which can occur if there are faulty junctions between the cables in outdoor or underwater applications. This innovation, patented by L&L, also guarantees electrical protection against polarity reversal, hot plugging, ESD and power surges, which can occur if there are faults in the electrical circuit; Operating temperature: -20°C — +45°C; Maximum device temperature: 40°C (Ta 25°C); Glow wire test: 960°; Photobiological safety: photobiological safety: risk group 1 according to EN 62471:2006; Appliance class: class III; Weight: 200 g; Dimensions: 47x47x63 mm; Cutout dimensions: 48x48 mm; Volume of thermal heatsink: Ø120x110 mm; Energy efficiency class: F (light source) in accordance with EU 2019/2015; Accessories: WC4011 Outer casing, WC4511 Outer casing for plasterboard, WE0601S Anti-glare screen, half transparent and half serigraphed black, WL0100 Suction cup; tested and approved via E.O.L. (End Of Line) test with functioning test and check of electrical power consumption

Status: Available

### ELECTRICAL CHARACTERISTICS

Power consumption	max 2W
Power supply	max 700mA
Power supply unit	power supply unit not included
Control system	dimming via dimmable driver
Wiring	series

### LIGHTING CHARACTERISTICS

Number and type of LED	1 power LED
Average LED life	50 000h L90 B10 (Ta 25°C)
LED colour	3000K
CRI Colour Rendering Index	>90
Binning	1/4 ANSI BIN
Optics	13°
Lumen output at source	196 lm (3000K, 700mA, CRI >90)
Delivered lumen output	165 lm (3000K, 700mA, 22°, CRI >90)

### MECHANICAL CHARACTERISTICS

Dimensions	47x47x63 mm
Weight	200 g
Mounting	with outer casing
Body material	body in black-anodized anticorrosive aluminium
Screen material	screen in serigraphed-grey and transparent, tempered extra-clear glass
Cutout dimensions	48x48 mm
Volume of thermal heatsink	Ø120x110 mm

### GENERAL CHARACTERISTICS

Ingress protection	IP67
Operating temperature	-20°C — +45°C
Impact resistance	IK08
Energy efficiency class	F (light source) in accordance with EU 2019/2015
Glow wire test	960°
Maximum device temperature	40°C (Ta 25°C)
Appliance class	class III
Walkover	yes
Drive-over	up to 1000 kg
Power cables	includes 1.5 m neoprene cable H05RN-F 2x0.75/0.75 Ø6.3 mm
Protection systems	IPS (Intelligent Protection System)
Photobiological safety	photobiological safety: risk group 1 according to EN 62471:2006
Notes	version with screen in serigraphed-white glass available on request; Casambi control using the Casambi app with dedicated electronics

## PHOTOMETRIC DATA

S - 13° CRI 80

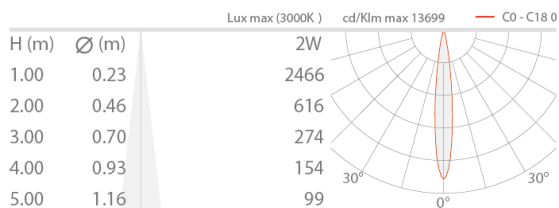

## ACCESSORIES

### Installation Accessories



**WC4011**  
Outer casing

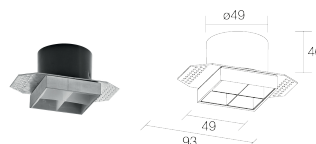

**WC4511**  
Outer casing for plasterboard

### Optical Accessories



#### WE0601S

Anti-glare screen, half transparent and half serigraphed black built into the lighting fixture  
Can be fitted on all optics except for 48° optics  
Order together with the lighting fixture

### Other



#### WL0100

Suction cup  
Recommended accessory

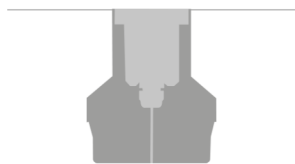

Installation flush with ground

L&L Luce&Light SRL reserves the right to change the information contained in this document at any time without prior notice being given.